

## CONTENTS:

Pos	Name:	Art no:	Pcs
1	Sunvisor 35 cm for all Scania NG Sunvisor 30 cm for all Scania NG Sunvisor BOW for all Scania NG Sunvisor FLAT for all Scania NG	111 112 113 114	
2	Mirror extender 170 mm for 35 and BOW Mirror extender 140 mm for 30 and FLAT	1182 1183	1 1
3	Mounting kit for mirror extender (A) Hexagonal screw M8x25 mm (B) Spring washer M8	1100	1 2 2

**IMPORTANT!**  
All installations should be done by experienced mechanics/vehicle electricians. In the event of your own modifications or making holes in the product, the warranty expires. Always follow the truck manufacturer's bodywork instructions regarding drilling and wiring in the cab. The same applies to the dimensioning of cables and the connection of lighting.

TruckStyle Sweden AB does not take responsibility for any damage that occurs in the event of an incorrect installation.

**IMPORTANT!** If your sunvisor is prepared for LED-bars, read the instruction for LED-bars first (1191/1192).

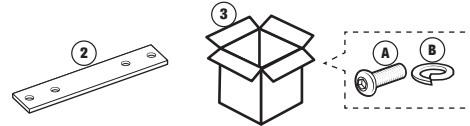
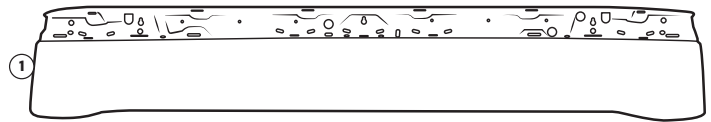

1. Remove the upper part to reuse later. Disconnect the connector (4) between the cab and the front mirror (1) and remove the front mirror from the cab by removing 2 screws (2). Disconnect any contact piece for position lights between the cab and the sunvisor. Remove position light (3) with associated cabling from the sunvisor.

**NOTE!** Save the position lights and associated wiring that will be reused for the new sunvisor.

1. Position light with connector
2. Screw M8x60
3. Front mirror
4. Front mirror cable & connector

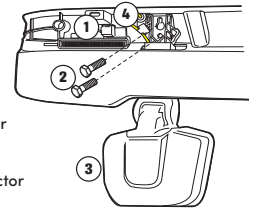

2. Remove the sunvisor from the cab by removing remaining 4 screws (1) & (2).

1. Screw M8x30
2. Screw M8x60

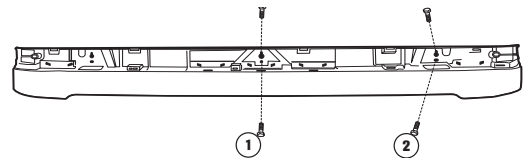

3. Place the mirror extender (1) on the front mirror with 2 screws (3) and spring washers (2).

1. Mirror extender
2. Spring washer M8
3. Hexagonal screw M8x25

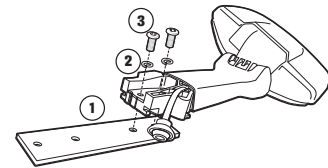

4. If equipped with position lights, fasten wiring to the position lights in the new sunvisor and use pre-drilled holes for cable ties.

5. Mount the sunvisor and the extended front mirror with the 6 Scania screws that was removed earlier (1).

1. Original Scania screw M8x60
2. Front mirror with mirror extender

**IMPORTANT!** If you are using spacers between the sunvisor and the cabin, you must replace the 2 middle screws with 2 that are M8x60.

**IMPORTANT!** If other accessories (for example lightboxes or light arcs) are to be mounted, but only use two of the sunvisor's attachment points, an equally thick spacer must be used in the positions not affected by the accessories. Be sure to make the spacer 80x50 mm x thickness of the accessory. The reason is to distribute the tension evenly. No gaps are allowed!

**IMPORTANT!** Tighten the screws by starting with the 2 middle screws and finally tightening the 4 outer ones.

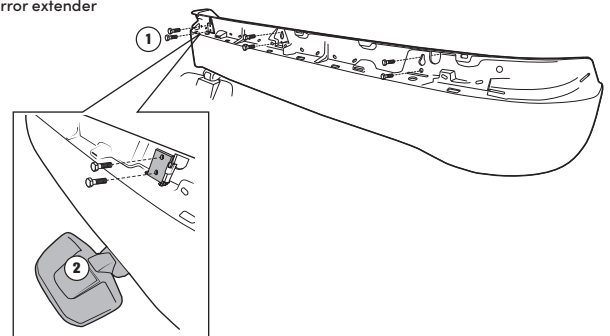

6. Connect the front mirror's connector (3) to the cab's connector. Before putting back the original upper part, check the function of the front mirror and same for the position lights if equipped.

1. Position light
2. Position light connector
3. Front mirror connector

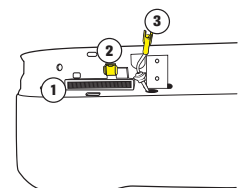

**IMPORTANT!** All cable entries in the cab must be sealed so that water cannot enter the cab.