

## CONTENTS:

Pos	Name:	Art no:	Pcs
1	Sunvisor Scania NG 35 cm prepared for Vision X Sunvisor Scania NG 30 cm prepared for Vision X Sunvisor Scania NG FLAT prepared for Vision X	11102 11202 11402	
2	Vision X kit* (A) Vision X LED-bars (B) Y-cable	8021	1 2 1
3	Mounting kit for Vision X (C) Bracket, left Lazer for Scania (D) Bracket, right Lazer for Scania (E) Special screw for bracket M8x25 mm (F) Washer 8,4x24x2 (G) Spacer Washer M8x3	1102	1 2 2 2 6 8

\*LED-bars and Y-cable only included with article number 8021



### IMPORTANT!

All installations should be done by experienced mechanics/vehicle electricians. In the event of your own modifications or making holes in the product, the warranty expires. Always follow the truck manufacturer's bodywork instructions regarding drilling and wiring in the cab. The same applies to the dimensioning of cables and the connection of lighting.

TruckStyle Sweden AB does not take responsibility for any damage that occurs in the event of an incorrect installation.

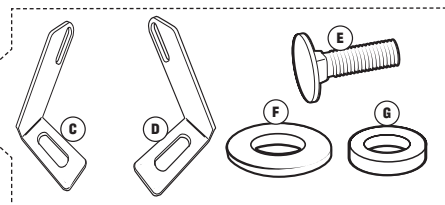
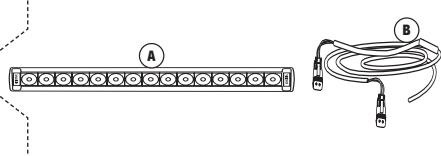
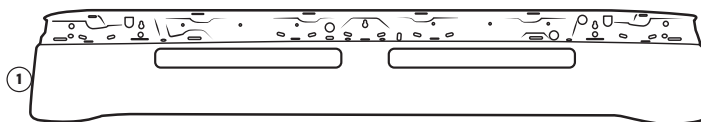

- Place the bracket (2) on the respective LED-bar (1) with attached fasteners (3-5). Repeat and place the fasteners on the next LED-bar.

- Right bracket
- LED-bar
- Left bracket
- Washer included in Vision X box
- 2x Spacer washer M8x3
- Square head screw M8x20 included in Vision X box

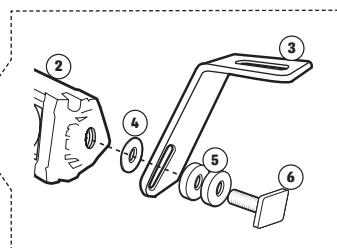
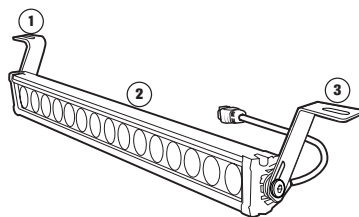

- Place the LED-bars in the sunvisor with the mounting hardware (1-6) in intended holes (yellow markings). Repeat and fit the fasteners on the other LED-bar.

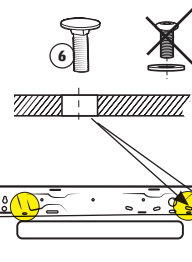
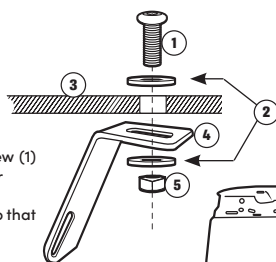

- Bolt M8 included in Vision X box
- Washer 8,4x24x2
- Sunvisor
- Bracket for LED-bar
- Locknut M8 included in Vision X box
- Special screw M8x25 for bracket



**NOTE!** If the new sunvisor has 5 or more position lights, the hexagonal screw (1) and flat washer (2) must be replaced with the bracket with special screw for bracket (6). Turn the head on the special screw for bracket (6) according to the picture, so that the recess in the bracket points in the travel direction of the truck.

- Run cables from the LED-bars with connectors through the holes (1) in the sunvisor. Then pull the Y-cable (2) through the hole (3) and out to the back of the sunvisor. Connect the Y-cable's connector to the LED-bar connector.

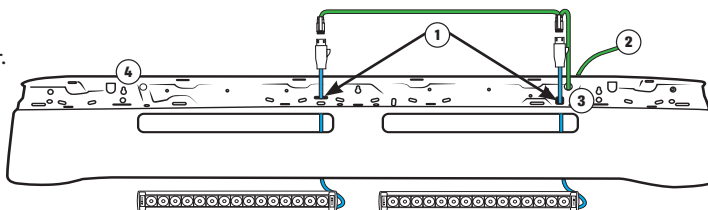

- Hole for LED-bar cable
- Y-cable
- Hole for Y-cable
- Alternate hole for Y-cable



**NOTE!** Depending on which side of the cab the electrical connection is to be made, the Y-cable (2) can also be turned and pulled through the hole (4) on the opposite side of the sunvisor.

- Pull 6 cable ties (1) from the back of the sunvisor through the pre-drilled holes and insert the wiring on the front of the sunvisor. Install any cabling for the position lights, use the pre-drilled holes for cable ties if more attachment points for the wiring are required.

- Cable tie
- Connector from LED-bar with cable tie
- Hole for cables

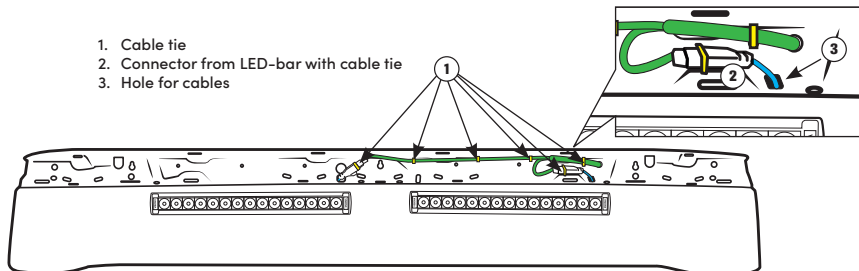

**IMPORTANT!** Attach the cable ties to the connectors as in the picture (2) so that the cables are centered in the holes (3).

- When the electrical connection between the vehicle and the LED-bars is done (performed by an automotive electrician) turn on the LED-bars and adjust the light pattern, finally tighten all the screws and nuts.