

CONTENTS:

Pos	Name:	Art no:	Pcs
1	Sunvisor for all Volvo FH/FM 4/5, FH16, Aero, Globetrotter + XL and FMX prepared for Lazer	21101	1
2	Lazer Linear kit* (A) Lazer Linear 18 LED-bars (B) Y-cable	8011/8012	2 2 1
3	Mounting kit for Lazer (C) Bracket, left Lazer for Volvo (D) Bracket, right Lazer for Volvo (E) Hexagonal screw M8x25 mm (F) Washer 8,4x24x2 mm (G) Locknut M8	2101	1 2 2 4 8 8 4

*LED-bars and Y-cable only included with article number: 8011/8012



IMPORTANT!

All installations should be done by experienced mechanics/vehicle electricians. In the event of your own modifications or making holes in the product, the warranty expires. Always follow the truck manufacturer's bodywork instructions regarding drilling and wiring in the cab. The same applies to the dimensioning of cabling and the connection of lighting.

TruckStyle Sweden AB does not take responsibility for any damage that occurs in the event of an incorrect installation.

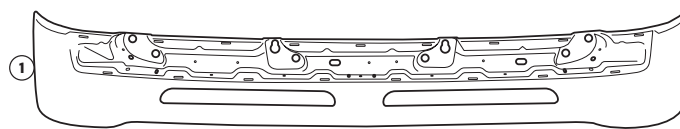

- Place the left bracket (3) and right bracket (1) on the respective LED-bar (2) with attached fasteners (4-6). Repeat and place the fasteners on the next LED-bar.

- Right bracket
- LED-bar
- Left bracket
- Washer M6 included in Lazer box
- Spring washer M6 included in Lazer box
- Hexagonal screw M6x15 included in Lazer box

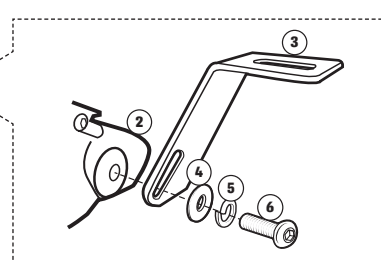
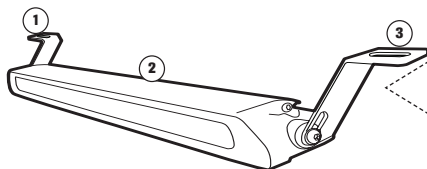

- Place the LED-bars in the sunvisor with mounting hardware (1-5) in intended holes (yellow marking). Repeat and fit the fasteners on the second LED-bar.

- Hexagonal screw M8x25
- Washer 8,4x24x2
- Sunvisor
- Bracket for LED-bar
- Locknut M8

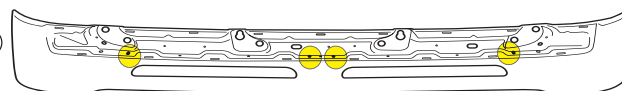
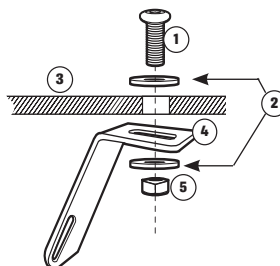

- Pull cables from the LED-bars with connectors through the holes (1) in the sunvisor. Then pull the Y-cable (2) through the hole (3) and out on the back of the sunvisor. Connect the Y-cable's connectors to the LED-bar connector.

- Hole for cable from LED-bars
- Y-cable
- Hole for Y-cable

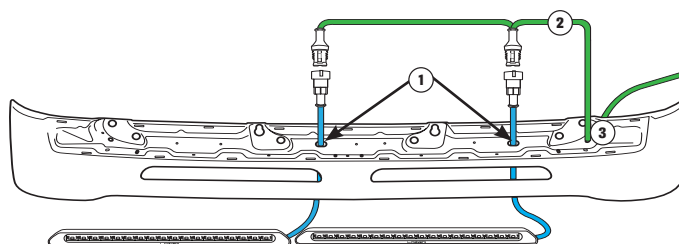

- Pull 5 cable ties (1) from the back of the sunvisor through the pre-drilled holes and fasten the wiring on the front of the sunvisor. Pull 1 cable tie (2) from the front through the pre-drilled hole and fasten the cable on the back of the sunvisor.

- Cable tie
- Cable tie

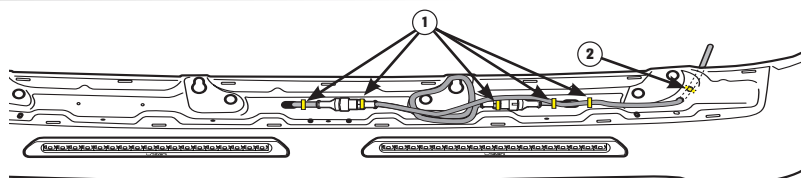

- When the electrical connection between the vehicle and the LED-bars is performed (performed by electrician). Turn on the LED-bars and adjust the light pattern, finally tighten all the screws and nuts.